

Ganged Wall Form System

The Most Versatile Wall Form System for all Applications.

Aluma SYSTEMS

Aluma Ganged Wall Form system combines the unique features and versatility of our Aluma Beams® with the unequalled strength of the aluminum 55K Strongback. Using a full range of proven accessories, this system can be used for all wall form configurations while maximizing labor savings through the use of lightweight aluminum.



Product Description

Wall Forming

Basic to the wall form is the Aluma Beam®. This lightweight, high strength aluminum component provides a wall form weighing only 8.5 lb. / sq.ft. (41.5kg/m²), including plywood. Because it is so light, the Aluma Wall Form is quick and easy to assemble, simple to handle, and any size form can be provided since the system can be assembled in any length or height required, using standard length Aluma Beam® and spliced strongbacks.

Using a spreader bar and lifting lugs, you can strip, fly, and re-set both sides of the wall simultaneously. The spreader bar maintains sufficient distance on re-setting to permit installation of reinforcing steel prior to closing up.

Tie locations are completely flexible and can be inserted at any location throughout the length of the strongback.

The Aluma Beam® can be used either horizontally with a vertical waler or vertically with a horizontal waler. This

makes the Aluma wall form system completely adaptable to a variety of wall configurations such as Y-walls, shafts, and circular walls.

The bolt slot in the bottom flange of the Aluma Beam® is repeated into the flanges of the strongback so that external accessories

can be attached easily. These may include catwalk brackets, plumbing and wind braces, etc. There is simply no other wall system available with the versatility offered by Aluma Systems.

The Ganged Wall Form conforms to all forming regulations, including CSA, CAL-OSHA AND ANSI.

Features

- Quick and easy assembly
- Versatile
- Made of lightweight high strength aluminum
- Comprised of Aluma Beams® and aluminum Strongbacks

Warning, Limitation of Aluma Systems Liability:

This bulletin is intended only for general information on the Ganged Wall Form. This product is only to be used for the purpose for which it is intended and only per the load capacities as established by Aluma Systems. This product must not be used when damaged and must be in fully functional condition. This product must be inspected by the user before use and properly stored, maintained and repaired. This product must not be misused nor overloaded.

Ganged Wall Form System

Ganged Wall Form Layout

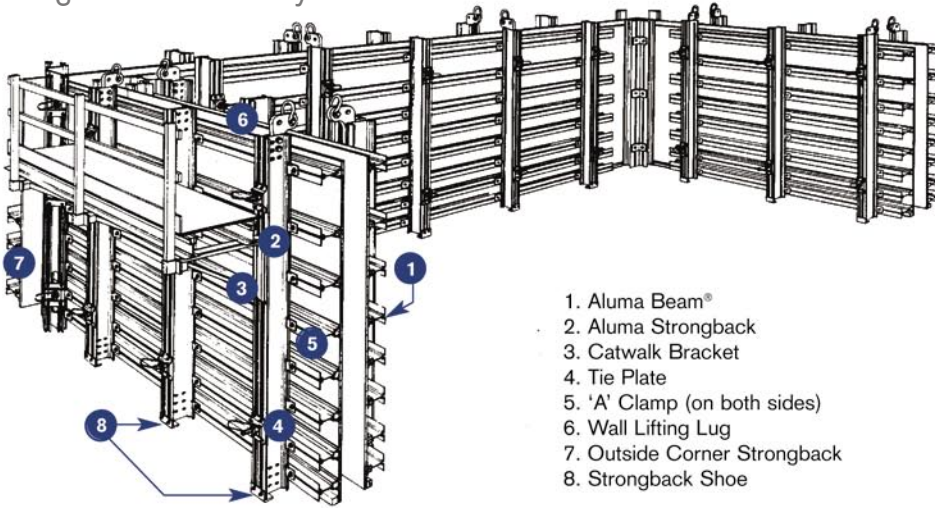

1. Aluma Beam®
2. Aluma Strongback
3. Catwalk Bracket
4. Tie Plate
5. 'A' Clamp (on both sides)
6. Wall Lifting Lug
7. Outside Corner Strongback
8. Strongback Shoe

Basic Components

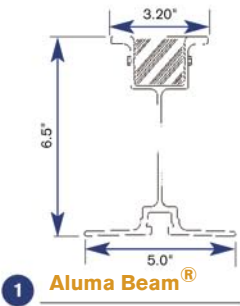

1 Aluma Beam®



Aluma Bolt
DIA. 1/2" x 2"
(13mm x 5mm)
Can be inserted anywhere along the beam slot due to its unique 'T' head design.

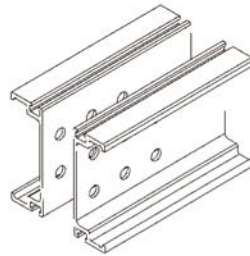

2 Aluma 55K Strongback

ITEM NO.	LENGTH FT. IN (MM)
122 Strongback Channel	8'6" (2591mm)
123 Strongback Channel	12'6" (3810mm)
124 Strongback Channel	16'0" (4877mm)

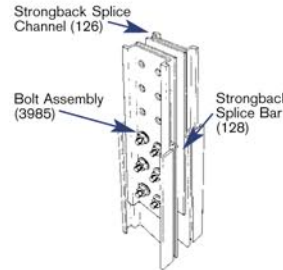

Strongback Splice Assembly

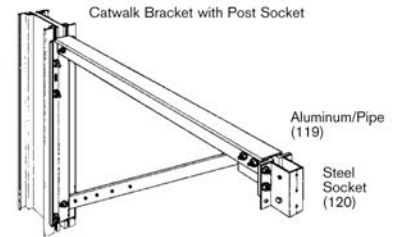

3 Bolted Catwalk Bracket Adjusts easily for battered walls

ITEM NO. 131
DESCRIPTION Catwalk bracket with post socket
Safe Working Load = 1,500 lb.
(680 kg) F.S. = 2.2:1
Bolts to Strongback using 6 bolts.

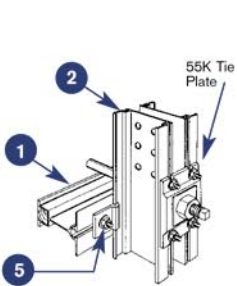

Beam/Strongback Connection

ITEM NO. 130
(two per strongback)

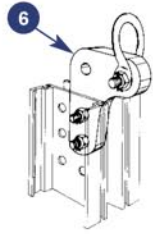

Wall Lifting Lug

ITEM NO. 144

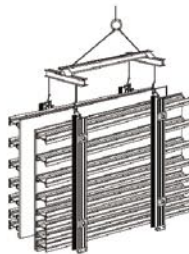

Typical Wall Form Section

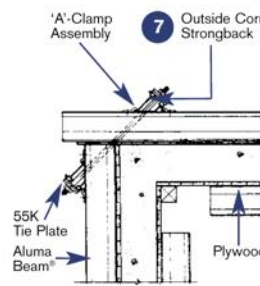

Inside/Outside Corner Detail

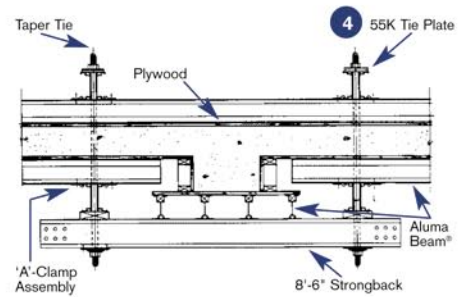

Pilaster Forms

CANADA

Calgary, AB T 403.212.4832	Ottawa, ON T 613.745.7081	Saskatoon, SK T 306.931.7888	Vancouver, BC T 604.940.3000
Edmonton, AB T 780.440.1692	Saint John, NB T 506.633.9820	St. John's, NL T 709.753.3325	Victoria, BC T 250.652.9409
Montreal, QC T 514.383.1985	Halifax, NS T 902.468.9533	Toronto, ON T 905.669.5282	Winnipeg, MB T 204.633.7072

USA

Atlanta, GA T 404.699.0979	Houston, TX T 832.226.5100	San Jose, CA T 408.238.6969
Baltimore, MD T 301.937.5090	Las Vegas, NV T 702.866.6513	Seattle, WA T 425.251.0270
Chicago, IL T 847.875.4526	Phoenix, AZ T 602.212.0350	Tampa, FL T 813.626.1133

INTERNATIONAL

International T 905.699.5282	Japan T +81.090.5797.0643	Middle East T +971.4.341.3717
Indonesia T +62.21.526.2405	Latvia/Baltics T +371.29.430.518	South East Asia T +65.6268.0375
Israel T +972.6.6769963	Mexico/S.America T +52.55.9000.3749	United Kingdom T +44.1702.232.464